



# Room Care R2-plus

## Hard surface cleaner and disinfectant - concentrate

### Description

Concentrated cleaner for the hygienic cleaning of all water resistant hard surfaces. To be used only with Divermite/DQFM dosing and dilution system. Also available in fully recyclable mono-material pouch.

### Key properties

- Formulated for the hygienic cleaning of hard, water-resistant surfaces
- Slightly alkaline
- Non-abrasive
- Light, delicate and fresh fragrance
- Unique, patented ONT air neutralising technology alters malodour molecules

### Benefits

- Leaves surfaces hygienically clean
- Quickly and gently removes oily and water-soluble residues
- Leaves a pleasant scent behind
- Neutralises malodour molecules, enhancing the effect of the perfume
- Colour and alphanumeric coded to prevent application mistakes

### Use instructions

1. Spray a small quantity onto a damp cloth/sponge pad and clean the surface.
2. Let product act for the required time according to the microbiological data.
3. Rinse with fresh water or wipe with a clean, damp cloth.
4. Buff with a dry cloth for extra shine.

For more detailed application, please refer to Room Care R2-plus Mini Guide.

### Dosage\*

- When using with Divermite Room Care dosing unit, dose 2x 15ml (10%) Room Care R2plus into keyed bottle filled with 300ml of cold water or 5x 15ml (10%) into keyed bottle filled with 750ml of cold water. Securely screw on the spray trigger, ensure the nozzle is closed and shake gently to mix.
- When using with DQFM dilution dispenser unit, fill the Room Care R2-plus keyed spray bottle to the fill level mark or the bucket directly from the DQFM dispenser. Securely screw-on the spray trigger.

Proper dosage saves costs and minimises environmental impact.

*\*This dosage is according to optimal conditions, recommendations may vary, please consult with your Diversey representative for directions.*

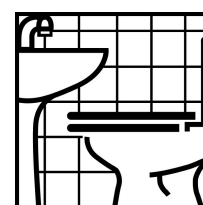
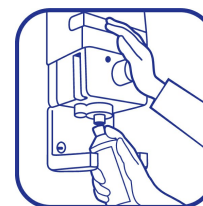

© A.I.S.E



# Room Care R2-plus

## Technical data

Appearance:	Clear dark green liquid
Odour:	Slightly perfumed
pH value (neat):	~ 11
pH value (in use):	~ 10.5
Relative density (g/cm <sup>3</sup> ; 20°C):	≈ 1.03
Viscosity (mPa.s; 25°C):	≈ 40

*The above data is typical of normal production and should not be taken as a specification.*

## Safe handling and storage information

Full guidance on the handling and disposal of this product is provided in a separate Safety Data Sheet; [sds.diversey.com](https://sds.diversey.com). Store in original closed containers away from extremes of temperature. Only for professional users / specialists. Use disinfectants safely. Always read the label and product information before use and follow local regulations and advisory.

## Product compatibility

Do not use on water-sensitive surfaces, e.g. wood. Test material compatibility in a small, inconspicuous place before use. Do not use with other dilution systems or methods. Do not use undiluted.

## Microbiological data

- Room Care R2-plus passed EN 1276 at 10% dilution in water of standardised hardness and in dirty conditions (0.3% bovine albumin) at a contact time of 1 minute.
- Room Care R2-plus passed EN 13697 at 10% dilution in water of standardised hardness and in dirty conditions (0.3% bovine albumin) for referenced strains *Staphylococcus aureus*, *Enterococcus hirae*, *Escherichia coli* and *Pseudomonas aeruginosa* at a contact time of 5 minutes. Yeastocidal activity in 15 minutes when diluted at 10% for the referenced strain *Candida albicans*.

## Environmental information

The surfactants used in this product are biodegradable in compliance with the requirement of EU Detergent Regulation, EC 648/2004.

Fully recyclable mono-material pouch with removable label and cap, so easy to recycle where the required infrastructure exists.

## Available pack sizes

Room Care R2-plus is available in a 2L pouch.

## [www.diversey.com](https://www.diversey.com)

© 2024 Diversey, Inc. All Rights Reserved. 20/03/2024 en (P99418)